

* required information

Section 1 of 21

You can save the form at any time and resume it later. You do not need to be logged in when you resume.

System reference

Not Currently In Use

This is the unique reference for this application generated by the system.

Your reference

You can put what you want here to help you track applications if you make lots of them. It is passed to the authority.

Are you an agent acting on behalf of the applicant?

☒ Yes ☐ No

Put "no" if you are applying on your own behalf or on behalf of a business you own or work for.

Applicant Details

* First name

Warren Theodore

* Family name

Richards

* E-mail

chris@knighttraining.co.uk

Main telephone number

Include country code.

Other telephone number

☐ Indicate here if the applicant would prefer not to be contacted by telephone

Is the applicant:

- ☒ Applying as a business or organisation, including as a sole trader
☐ Applying as an individual

A sole trader is a business owned by one person without any special legal structure. Applying as an individual means the applicant is applying so the applicant can be employed, or for some other personal reason, such as following a hobby.

Applicant Business

Is the applicant's business registered in the UK with Companies House?

☒ Yes ☐ No

Note: completing the Applicant Business section is optional in this form.

Registration number

12309639

Business name

Café Caribbean (Loughton) Ltd

If the applicant's business is registered, use its registered name.

VAT number

none

Put "none" if the applicant is not registered for VAT.

Legal status

Private Limited Company

Continued from previous page...

Applicant's position in the business

Home country

The country where the applicant's headquarters are.

Registered Address

Address registered with Companies House.

Building number or name

Street

District

City or town

County or administrative area

Postcode

Country

Agent Details

* First name

* Family name

* E-mail

Main telephone number

Include country code.

Other telephone number

☐ Indicate here if you would prefer not to be contacted by telephone

Are you:

☒ An agent that is a business or organisation, including a sole trader

☐ A private individual acting as an agent

A sole trader is a business owned by one person without any special legal structure.

Agent Business

Is your business registered in the UK with Companies House? ☒ Yes ☐ No

Note: completing the Applicant Business section is optional in this form.

Registration number

Business name

If your business is registered, use its registered name.

VAT number

Put "none" if you are not registered for VAT.

Legal status

Continued from previous page...

Your position in the business	<input type="text" value="Licensing Agent"/>	
Home country	<input type="text" value="United Kingdom"/>	The country where the headquarters of your business is located.
Agent Registered Address		Address registered with Companies House.
Building number or name	<input type="text" value="134 The Barracks"/>	
Street	<input type="text" value="South Road"/>	
District	<input type="text" value="White Cross"/>	
City or town	<input type="text" value="LANCASTER"/>	
County or administrative area	<input type="text"/>	
Postcode	<input type="text" value="LA1 4XQ"/>	
Country	<input type="text" value="United Kingdom"/>	

Section 2 of 21

PREMISES DETAILS

I/we, as named in section 1, apply for a premises licence under section 17 of the Licensing Act 2003 for the premises described in section 2 below (the premises) and I/we are making this application to you as the relevant licensing authority in accordance with section 12 of the Licensing Act 2003.

Premises Address

Are you able to provide a postal address, OS map reference or description of the premises?

☒ Address ☐ OS map reference ☐ Description

Postal Address Of Premises

Building number or name	<input type="text" value="Café Caribbean, 262"/>
Street	<input type="text" value="High Road"/>
District	<input type="text"/>
City or town	<input type="text" value="LOUGHTON"/>
County or administrative area	<input type="text"/>
Postcode	<input type="text" value="IG10 1RB"/>
Country	<input type="text" value="United Kingdom"/>

Further Details

Telephone number	<input type="text"/>
Non-domestic rateable value of premises (£)	<input type="text" value="21,090"/>

Section 3 of 21

APPLICATION DETAILS

In what capacity are you applying for the premises licence?

- ☐ An individual or individuals
- ☒ A limited company / limited liability partnership
- ☐ A partnership (other than limited liability)
- ☐ An unincorporated association
- ☐ Other (for example a statutory corporation)
- ☐ A recognised club
- ☐ A charity
- ☐ The proprietor of an educational establishment
- ☐ A health service body
- ☐ A person who is registered under part 2 of the Care Standards Act 2000 (c14) in respect of an independent hospital in Wales
- ☐ A person who is registered under Chapter 2 of Part 1 of the Health and Social Care Act 2008 in respect of the carrying on of a regulated activity (within the meaning of that Part) in an independent hospital in England
- ☐ The chief officer of police of a police force in England and Wales

Confirm The Following

- ☒ I am carrying on or proposing to carry on a business which involves the use of the premises for licensable activities
- ☐ I am making the application pursuant to a statutory function
- ☐ I am making the application pursuant to a function discharged by virtue of Her Majesty's prerogative

Section 4 of 21

NON INDIVIDUAL APPLICANTS

Provide name and registered address of applicant in full. Where appropriate give any registered number. In the case of a partnership or other joint venture (other than a body corporate), give the name and address of each party concerned.

Non Individual Applicant's Name

Name

Details

Registered number (where applicable)

Description of applicant (for example partnership, company, unincorporated association etc)

Continued from previous page...

Private Limited Company

Address

Building number or name

Street

District

City or town

County or administrative area

Postcode

Country

Contact Details

E-mail

Telephone number

Other telephone number

* Date of birth / /
dd mm yyyy

* Nationality

Documents that demonstrate entitlement to work in the UK

Section 5 of 21

OPERATING SCHEDULE

When do you want the premises licence to start? / /
dd mm yyyy

If you wish the licence to be valid only for a limited period, when do you want it to end / /
dd mm yyyy

Provide a general description of the premises

For example the type of premises, its general situation and layout and any other information which could be relevant to the licensing objectives. Where your application includes off-supplies of alcohol and you intend to provide a place for consumption of these off-supplies you must include a description of where the place will be and its proximity to the premises.

Café/restaurant serving Caribbean Food

Continued from previous page...

If 5,000 or more people are expected to attend the premises at any one time, state the number expected to attend

Section 6 of 21

PROVISION OF PLAYS

See guidance on regulated entertainment

Will you be providing plays?

☐ Yes

☒ No

Section 7 of 21

PROVISION OF FILMS

See guidance on regulated entertainment

Will you be providing films?

☐ Yes

☒ No

Section 8 of 21

PROVISION OF INDOOR SPORTING EVENTS

See guidance on regulated entertainment

Will you be providing indoor sporting events?

☐ Yes

☒ No

Section 9 of 21

PROVISION OF BOXING OR WRESTLING ENTERTAINMENTS

See guidance on regulated entertainment

Will you be providing boxing or wrestling entertainments?

☐ Yes

☒ No

Section 10 of 21

PROVISION OF LIVE MUSIC

See guidance on regulated entertainment

Will you be providing live music?

☒ Yes

☐ No

Standard Days And Timings

MONDAY

Start

End

Start

End

TUESDAY

Start

End

Start

End

Give timings in 24 hour clock.
(e.g., 16:00) and only give details for the days
of the week when you intend the premises
to be used for the activity.

Continued from previous page...

WEDNESDAY

Start

End

Start

End

THURSDAY

Start

End

Start

End

FRIDAY

Start

End

Start

End

SATURDAY

Start

End

Start

End

SUNDAY

Start

End

Start

End

Will the performance of live music take place indoors or outdoors or both?

☒ Indoors

☐ Outdoors

☐ Both

Where taking place in a building or other structure tick as appropriate. Indoors may include a tent.

State type of activity to be authorised, if not already stated, and give relevant further details, for example (but not exclusively) whether or not music will be amplified or unamplified.

State any seasonal variations for the performance of live music

For example (but not exclusively) where the activity will occur on additional days during the summer months.

Non-standard timings. Where the premises will be used for the performance of live music at different times from those listed in the column on the left, list below

For example (but not exclusively), where you wish the activity to go on longer on a particular day e.g. Christmas Eve.

Continued from previous page...

Section 11 of 21

PROVISION OF RECORDED MUSIC

See guidance on regulated entertainment

Will you be providing recorded music?

☒ Yes

☐ No

Standard Days And Timings

MONDAY

Start

End

Start

End

Give timings in 24 hour clock.
(e.g., 16:00) and only give details for the days
of the week when you intend the premises
to be used for the activity.

TUESDAY

Start

End

Start

End

WEDNESDAY

Start

End

Start

End

THURSDAY

Start

End

Start

End

FRIDAY

Start

End

Start

End

SATURDAY

Start

End

Start

End

SUNDAY

Start

End

Start

End

Will the playing of recorded music take place indoors or outdoors or both?

☒ Indoors

☐ Outdoors

☐ Both

Where taking place in a building or other
structure tick as appropriate. Indoors may
include a tent.

State type of activity to be authorised, if not already stated, and give relevant further details, for example (but not
exclusively) whether or not music will be amplified or unamplified.

Continued from previous page...

State any seasonal variations for playing recorded music

For example (but not exclusively) where the activity will occur on additional days during the summer months.

Non-standard timings. Where the premises will be used for the playing of recorded music at different times from those listed in the column on the left, list below

For example (but not exclusively), where you wish the activity to go on longer on a particular day e.g. Christmas Eve.

Section 12 of 21

PROVISION OF PERFORMANCES OF DANCE

See guidance on regulated entertainment

Will you be providing performances of dance?

☐ Yes

☒ No

Section 13 of 21

PROVISION OF ANYTHING OF A SIMILAR DESCRIPTION TO LIVE MUSIC, RECORDED MUSIC OR PERFORMANCES OF DANCE

See guidance on regulated entertainment

Will you be providing anything similar to live music, recorded music or performances of dance?

☐ Yes

☒ No

Section 14 of 21

LATE NIGHT REFRESHMENT

Will you be providing late night refreshment?

☒ Yes

☐ No

Standard Days And Timings

MONDAY

Start

End

Start

End

TUESDAY

Start

End

Start

End

Give timings in 24 hour clock.
(e.g., 16:00) and only give details for the days
of the week when you intend the premises
to be used for the activity.

Continued from previous page...

WEDNESDAY

Start	23:00	End	23:30
Start		End	

THURSDAY

Start	23:00	End	23:30
Start		End	

FRIDAY

Start	23:00	End	00:30
Start		End	

SATURDAY

Start	23:00	End	00:30
Start		End	

SUNDAY

Start	23:00	End	23:30
Start		End	

Will the provision of late night refreshment take place indoors or outdoors or both?

☒ Indoors ☐ Outdoors ☐ Both

Where taking place in a building or other structure tick as appropriate. Indoors may include a tent.

State type of activity to be authorised, if not already stated, and give relevant further details, for example (but not exclusively) whether or not music will be amplified or unamplified.

State any seasonal variations

For example (but not exclusively) where the activity will occur on additional days during the summer months.

Non-standard timings. Where the premises will be used for the supply of late night refreshments at different times from those listed in the column on the left, list below

For example (but not exclusively), where you wish the activity to go on longer on a particular day e.g. Christmas Eve.

Continued from previous page...

Section 15 of 21

SUPPLY OF ALCOHOL

Will you be selling or supplying alcohol?

☒ Yes

☐ No

Standard Days And Timings

MONDAY

Start 11:00

End 23:00

Start

End

Give timings in 24 hour clock.
(e.g., 16:00) and only give details for the days
of the week when you intend the premises
to be used for the activity.

TUESDAY

Start 11:00

End 23:00

Start

End

WEDNESDAY

Start 11:00

End 23:00

Start

End

THURSDAY

Start 11:00

End 23:00

Start

End

FRIDAY

Start 11:00

End 00:00

Start

End

SATURDAY

Start 11:00

End 00:00

Start

End

SUNDAY

Start 11:00

End 23:00

Start

End

Will the sale of alcohol be for consumption:

☐ On the premises

☐ Off the premises

☒ Both

If the sale of alcohol is for consumption on
the premises select on, if the sale of alcohol
is for consumption away from the premises
select off. If the sale of alcohol is for
consumption on the premises and away
from the premises select both.

Continued from previous page...

State any seasonal variations

For example (but not exclusively) where the activity will occur on additional days during the summer months.

Non-standard timings. Where the premises will be used for the supply of alcohol at different times from those listed in the column on the left, list below

For example (but not exclusively), where you wish the activity to go on longer on a particular day e.g. Christmas Eve.

State the name and details of the individual whom you wish to specify on the licence as premises supervisor

Name

First name

Warren Theodore

Family name

Richards

Date of birth

/ /
dd mm yyyy

Enter the contact's address

Building number or name

Street

District

City or town

LOUGHTON

County or administrative area

Postcode

Country

United Kingdom

Personal Licence number
(if known)

Issuing licensing authority
(if known)

Epping Forest District Council

PROPOSED DESIGNATED PREMISES SUPERVISOR CONSENT

How will the consent form of the proposed designated premises supervisor be supplied to the authority?

Continued from previous page...

- ☐ Electronically, by the proposed designated premises supervisor
- ☒ As an attachment to this application

Reference number for consent form (if known)

If the consent form is already submitted, ask the proposed designated premises supervisor for its 'system reference' or 'your reference'.

Section 16 of 21

ADULT ENTERTAINMENT

Highlight any adult entertainment or services, activities, or other entertainment or matters ancillary to the use of the premises that may give rise to concern in respect of children

Give information about anything intended to occur at the premises or ancillary to the use of the premises which may give rise to concern in respect of children, regardless of whether you intend children to have access to the premises, for example (but not exclusively) nudity or semi-nudity, films for restricted age groups etc gambling machines etc.

N/A

Section 17 of 21

HOURS PREMISES ARE OPEN TO THE PUBLIC

Standard Days And Timings

MONDAY

Start 11:00

End 23:30

Start

End

Give timings in 24 hour clock. (e.g., 16:00) and only give details for the days of the week when you intend the premises to be used for the activity.

TUESDAY

Start 11:00

End 23:30

Start

End

WEDNESDAY

Start 11:00

End 23:30

Start

End

THURSDAY

Start 11:00

End 23:30

Start

End

FRIDAY

Start 11:00

End 00:30

Start

End

Continued from previous page...

SATURDAY

Start 11:00

End 00:30

Start

End

SUNDAY

Start 11:00

End 23:30

Start

End

State any seasonal variations

For example (but not exclusively) where the activity will occur on additional days during the summer months.

Non standard timings. Where you intend to use the premises to be open to the members and guests at different times from those listed in the column on the left, list below

For example (but not exclusively), where you wish the activity to go on longer on a particular day e.g. Christmas Eve.

Section 18 of 21

LICENSING OBJECTIVES

Describe the steps you intend to take to promote the four licensing objectives:

a) General – all four licensing objectives (b,c,d,e)

List here steps you will take to promote all four licensing objectives together.

Consideration of the Epping Forest District Council Licensing policy and have been carried out to ensure the promotion of the four licensing objectives

b) The prevention of crime and disorder

A camera CCTV system is in place covering all public areas of the premises

The CCTV system shall continuously record whilst the premises is open for licensable activities and during all times when customers remain on the premises. All recordings will be stored for a minimum of 31 days and can be accessed and downloaded immediately when requested by the police or other authorised officer

There will always be at least one person present whilst the premises is open to the public who is able to operate and download images from the CCTV

An incident log shall be kept at the premises, and made available on request to the police or an authorised officer, which will record the following:

- o All crimes reported to the venue
- o Any complaints received
- o Any incidents of disorder
- o Any faults in the CCTV system

Continued from previous page...

- o Any visit by a relevant authority or emergency service
- o All ejections of patrons
- o All seizures of drugs or offensive weapons
- o Any refusal of the sale of alcohol

c) Public safety

The premises will be maintained in a safe manner at all times
All exits will be kept unobstructed, easy to open and clearly signed

d) The prevention of public nuisance

Sales of alcohol for consumption off the premises will only be supplied with, and ancillary to, a take-away meal
All refuse will be disposed of in an appropriate manner. Staff will be instructed to maintain all external areas in a clean and presentable manner at all times
Notices will be displayed asking patrons to leave the premises quietly and to have respect for local residents
Substantial food and non-intoxicating beverages, including drinking water, shall be available in all parts of the premises where alcohol is sold or supplied for consumption on the premises
No noise generated on the premises, or by its associated plant or equipment, shall emanate from the premises nor vibration be transmitted through the structure of the premises which gives rise to a nuisance
No fumes, steam or odours shall be emitted from the licensed premises so as to cause a nuisance to any persons living or carrying on business in the area where the premises are situated
Staff shall monitor customers smoking outside the premises on a regular basis and ensure patrons do not cause a public nuisance
No deliveries to the premises shall take place between 23:00 and 07:00 on the following day
No waste or recyclable materials, including bottles, shall be moved, removed from or placed in outside areas between 23:00 hours and 07:00 hours on the following day

e) The protection of children from harm

A Challenge 25 proof of age scheme shall be operated at the premises where the only acceptable forms of ID are recognised photographic identification cards, such as a driving licence, passport or proof of age card with the PASS hologram
The premises will operate a "No ID, No Sale" policy at all times for persons who look under 25
Staff will be trained in the understanding of this policy and training records maintained for inspection if requested by the police or any other responsible authority
A record shall be kept detailing all refused sale of alcohol. The record should include the date and time of the refused sale and the name of the member of staff who refused the sale. The record shall be available for inspection at the premises by the police or an authorised officer of the Council at all times whilst the premises is open

Section 19 of 21

NOTES ON DEMONSTRATING ENTITLEMENT TO WORK IN THE UK

Continued from previous page...

Entitlement to work/immigration status for individual applicants and applications from partnerships which are not limited liability partnerships:

A licence may not be held by an individual or an individual in a partnership who is resident in the UK who:

- does not have the right to live and work in the UK; or
- is subject to a condition preventing him or her from doing work relating to the carrying on of a licensable activity.

Any premises licence issued in respect of an application made on or after 6 April 2017 will become invalid if the holder ceases to be entitled to work in the UK.

Applicants must demonstrate that they have an entitlement to work in the UK and are not subject to a condition preventing them from doing work relating to the carrying on of a licensable activity. They do this in one of two ways: 1) by providing with this application copies or scanned copies of the documents listed below (which do not need to be certified), or 2) by providing their 'share code' to enable the licensing authority to carry out a check using the Home Office online right to work checking service (see below).

Documents which demonstrate entitlement to work in the UK

- An expired or current passport showing the holder, or a person named in the passport as the child of the holder, is a British citizen or a citizen of the UK and Colonies having the right of abode in the UK [please see note below about which sections of the passport to copy].
- An expired or current passport or national identity card showing the holder, or a person named in the passport as the child of the holder, is a national of a European Economic Area country or Switzerland.
- A Registration Certificate or document certifying permanent residence issued by the Home Office to a national of a European Economic Area country or Switzerland.
- A Permanent Residence Card issued by the Home Office to the family member of a national of a European Economic Area country or Switzerland.
- A **current** Biometric Immigration Document (Biometric Residence Permit) issued by the Home Office to the holder indicating that the person named is allowed to stay indefinitely in the UK, or has no time limit on their stay in the UK.
- A **current** passport endorsed to show that the holder is exempt from immigration control, is allowed to stay indefinitely in the UK, has the right of abode in the UK, or has no time limit on their stay in the UK.
- A **current** Immigration Status Document issued by the Home Office to the holder with an endorsement indicating that the named person is allowed to stay indefinitely in the UK or has no time limit on their stay in the UK, **when produced in combination with** an official document giving the person's permanent National Insurance number and their name issued by a Government agency or a previous employer.
- A birth or adoption certificate issued in the UK, **when produced in combination with** an official document giving the person's permanent National Insurance number and their name issued by a Government agency or a previous employer.
- A birth or adoption certificate issued in the Channel Islands, the Isle of Man or Ireland **when produced in combination with** an official document giving the person's permanent National Insurance number and their name issued by a Government agency or a previous employer.
- A certificate of registration or naturalisation as a British citizen, **when produced in combination with** an official document giving the person's permanent National Insurance number and their name issued by a Government agency or a previous employer.

Continued from previous page...

- A **current** passport endorsed to show that the holder is allowed to stay in the UK and is currently allowed to work and is not subject to a condition preventing the holder from doing work relating to the carrying on of a licensable activity.
- A **current** Biometric Immigration Document (Biometric Residence Permit) issued by the Home Office to the holder which indicates that the named person can currently stay in the UK and is allowed to work relation to the carrying on of a licensable activity.
- A **current** Residence Card issued by the Home Office to a person who is not a national of a European Economic Area state or Switzerland but who is a family member of such a national or who has derivative rights or residence.
- A **current** Immigration Status Document containing a photograph issued by the Home Office to the holder with an endorsement indicating that the named person may stay in the UK, and is allowed to work and is not subject to a condition preventing the holder from doing work relating to the carrying on of a licensable activity **when produced in combination with** an official document giving the person's permanent National Insurance number and their name issued by a Government agency or a previous employer.
- A Certificate of Application, **less than 6 months old**, issued by the Home Office under regulation 18(3) or 20(2) of the Immigration (European Economic Area) Regulations 2016, to a person who is not a national of a European Economic Area state or Switzerland but who is a family member of such a national or who has derivative rights of residence.
- Reasonable evidence that the person has an outstanding application to vary their permission to be in the UK with the Home Office such as the Home Office acknowledgement letter or proof of postage evidence, or reasonable evidence that the person has an appeal or administrative review pending on an immigration decision, such as an appeal or administrative review reference number.
- Reasonable evidence that a person who is not a national of a European Economic Area state or Switzerland but who is a family member of such a national or who has derivative rights of residence in exercising treaty rights in the UK including:-
 - evidence of the applicant's own identity – such as a passport,
 - evidence of their relationship with the European Economic Area family member – e.g. a marriage certificate, civil partnership certificate or birth certificate, and
 - evidence that the European Economic Area national has a right of permanent residence in the UK or is one of the following if they have been in the UK for more than 3 months:
 - (i) working e.g. employment contract, wage slips, letter from the employer,
 - (ii) self-employed e.g. contracts, invoices, or audited accounts with a bank,
 - (iii) studying e.g. letter from the school, college or university and evidence of sufficient funds; or
 - (iv) self-sufficient e.g. bank statements.

Family members of European Economic Area nationals who are studying or financially independent must also provide evidence that the European Economic Area national and any family members hold comprehensive sickness insurance in the UK. This can include a private medical insurance policy, an EHIC card or an S1, S2 or S3 form.

Original documents must not be sent to licensing authorities. If the document copied is a passport, a copy of the following pages should be provided:-

- (i) any page containing the holder's personal details including nationality;
- (ii) any page containing the holder's photograph;
- (iii) any page containing the holder's signature;
- (iv) any page containing the date of expiry; and
- (v) any page containing information indicating the holder has permission to enter or remain in the UK and is permitted to work.

Continued from previous page...

If the document is not a passport, a copy of the whole document should be provided.

Your right to work will be checked as part of your licensing application and this could involve us checking your immigration status with the Home Office. We may otherwise share information with the Home Office. Your licence application will not be determined until you have complied with this guidance.

Home Office online right to work checking service

As an alternative to providing a copy of the documents listed above, applicants may demonstrate their right to work by allowing the licensing authority to carry out a check with the Home Office online right to work checking service.

To demonstrate their right to work via the Home Office online right to work checking service, applicants should include in this application their 9-digit share code (provided to them upon accessing the service at <https://www.gov.uk/prove-right-to-work>) which, along with the applicant's date of birth (provided within this application), will allow the licensing authority to carry out the check.

In order to establish the applicant's right to work, the check will need to indicate that the applicant is allowed to work in the United Kingdom and is not subject to a condition preventing them from doing work relating to the carrying on of a licensable activity.

An online check will not be possible in all circumstances because not all applicants will have an immigration status that can be checked online. The Home Office online right to work checking service sets out what information and/or documentation applicants will need in order to access the service. Applicants who are unable to obtain a share code from the service should submit copy documents as set out above.

Section 20 of 21

NOTES ON REGULATED ENTERTAINMENT

Continued from previous page...

In terms of specific **regulated entertainments** please note that:

- Plays: no licence is required for performances between 08:00 and 23:00 on any day, provided that the audience does not exceed 500.
- Films: no licence is required for 'not-for-profit' film exhibition held in community premises between 08:00 and 23:00 on any day provided that the audience does not exceed 500 and the organiser (a) gets consent to the screening from a person who is responsible for the premises; and (b) ensures that each such screening abides by age classification ratings.
- Indoor sporting events: no licence is required for performances between 08:00 and 23:00 on any day, provided that the audience does not exceed 1000.
- Boxing or Wrestling Entertainment: no licence is required for a contest, exhibition or display of Greco-Roman wrestling, or freestyle wrestling between 08:00 and 23:00 on any day, provided that the audience does not exceed 1000. Combined fighting sports – defined as a contest, exhibition or display which combines boxing or wrestling with one or more martial arts – are licensable as a boxing or wrestling entertainment rather than an indoor sporting event.
- Live music: no licence permission is required for:
 - o a performance of unamplified live music between 08:00 and 23:00 on any day, on any premises.
 - o a performance of amplified live music between 08:00 and 23:00 on any day on premises authorised to sell alcohol for consumption on those premises, provided that the audience does not exceed 500.
 - o a performance of amplified live music between 08:00 and 23:00 on any day, in a workplace that is not licensed to sell alcohol on those premises, provided that the audience does not exceed 500.
 - o a performance of amplified live music between 08:00 and 23:00 on any day, in a church hall, village hall, community hall, or other similar community premises, that is not licensed by a premises licence to sell alcohol, provided that (a) the audience does not exceed 500, and (b) the organiser gets consent for the performance from a person who is responsible for the premises.
 - o a performance of amplified live music between 08:00 and 23:00 on any day, at the non-residential premises of (i) a local authority, or (ii) a school, or (iii) a hospital, provided that (a) the audience does not exceed 500, and (b) the organiser gets consent for the performance on the relevant premises from: (i) the local authority concerned, or (ii) the school or (iii) the health care provider for the hospital.
- Recorded Music: no licence permission is required for:
 - o any playing of recorded music between 08:00 and 23:00 on any day on premises authorised to sell alcohol for consumption on those premises, provided that the audience does not exceed 500.
 - o any playing of recorded music between 08:00 and 23:00 on any day, in a church hall, village hall, community hall, or other similar community premises, that is not licensed by a premises licence to sell alcohol, provided that (a) the audience does not exceed 500, and (b) the organiser gets consent for the performance from a person who is responsible for the premises.
 - o any playing of recorded music between 08:00 and 23:00 on any day, at the non-residential premises of (i) a local authority, or (ii) a school, or (iii) a hospital, provided that (a) the audience does not exceed 500, and (b) the organiser gets consent for the performance on the relevant premises from: (i) the local authority concerned, or (ii) the school proprietor or (iii) the health care provider for the hospital.

Continued from previous page...

- Dance: no licence is required for performances between 08.00 and 23.00 on any day, provided that the audience does not exceed 500. However, a performance which amounts to adult entertainment remains licensable.
- Cross activity exemptions: no licence is required between 08.00 and 23.00 on any day, with no limit on audience size for:
 - any entertainment taking place on the premises of the local authority where the entertainment is provided by or on behalf of the local authority;
 - any entertainment taking place on the hospital premises of the health care provider where the entertainment is provided by or on behalf of the health care provider;
 - any entertainment taking place on the premises of the school where the entertainment is provided by or on behalf of the school proprietor; and
 - any entertainment (excluding films and a boxing or wrestling entertainment) taking place at a travelling circus, provided that (a) it takes place within a moveable structure that accommodates the audience, and (b) that the travelling circus has not been located on the same site for more than 28 consecutive days.

Section 21 of 21

PAYMENT DETAILS

This fee must be paid to the authority. If you complete the application online, you must pay it by debit or credit card.

Premises Licence Fees are determined by the non-domestic rateable value of the premises.

To find out a premises non domestic rateable value go to the Valuation Office Agency site at http://www.voa.gov.uk/business_rates/index.htm

Band A - No RV to £4300 £100.00

Band B - £4301 to £33000 £190.00

Band C - £33001 to £8700 £315.00

Band D - £87001 to £12500 £450.00*

Band E - £125001 and over £635.00*

*If the premises rateable value is in Bands D or E and the premises is primarily used for the consumption of alcohol on the premises then you are required to pay a higher fee

Band D - £87001 to £12500 £900.00

Band E - £125001 and over £1,905.00

There is an exemption from the payment of fees in relation to the provision of regulated entertainment at church halls, chapel halls or premises of a similar nature, village halls, parish or community halls, or other premises of a similar nature. The costs associated with these licences will be met by central Government. If, however, the licence also authorises the use of the premises for the supply of alcohol or the provision of late night refreshment, a fee will be required.

Schools and sixth form colleges are exempt from the fees associated with the authorisation of regulated entertainment where the entertainment is provided by and at the school or college and for the purposes of the school or college.

If you operate a large event you are subject to ADDITIONAL fees based upon the number in attendance at any one time

Capacity 5000-9999 £1,000.00

Capacity 10000 -14999 £2,000.00

Capacity 15000-19999 £4,000.00

Capacity 20000-29999 £8,000.00

Capacity 30000-39000 £16,000.00

Capacity 40000-49999 £24,000.00

Capacity 50000-59999 £32,000.00

Capacity 60000-69999 £40,000.00

Capacity 70000-79999 £48,000.00

Capacity 80000-89999 £56,000.00

Capacity 90000 and over £64,000.00

* Fee amount (£)

190.00

DECLARATION

1

Continued from previous page...

[Applicable to individual applicants only, including those in a partnership which is not a limited liability partnership] I understand I am not entitled to be issued with a licence if I do not have the entitlement to live and work in the UK (or if I am subject to a condition preventing me from doing work relating to the carrying on of a licensable activity) and that my licence will become invalid if I cease to be entitled to live and work in the UK. The DPS named in this application form is entitled to work in the UK (and is not subject to conditions preventing him or her from doing work relating to a licensable activity) and I have seen a copy of his or her proof of entitlement to work, if appropriate

☒ Ticking this box indicates you have read and understood the above declaration

This section should be completed by the applicant, unless you answered "Yes" to the question "Are you an agent acting on behalf of the applicant?"

* Full name

* Capacity

* Date / /
dd mm yyyy

Once you're finished you need to do the following:

1. Save this form to your computer by clicking file/save as...
2. Go back to <https://www.gov.uk/apply-for-a-licence/premises-licence/epping-forest/apply-1> to upload this file and continue with your application.

Don't forget to make sure you have all your supporting documentation to hand.

IT IS AN OFFENCE LIABLE TO SUMMARY CONVICTION TO A FINE OF ANY AMOUNT UNDER SECTION 158 OF THE LICENSING ACT 2003, TO MAKE A FALSE STATEMENT IN OR IN CONNECTION WITH THIS APPLICATION

IT IS AN OFFENCE UNDER SECTION 24B OF THE IMMIGRATION ACT 1971 FOR A PERSON TO WORK WHEN THEY KNOW, OR HAVE REASONABLE CAUSE TO BELIEVE, THAT THEY ARE DISQUALIFIED FROM DOING SO BY REASON OF THEIR IMMIGRATION STATUS. THOSE WHO EMPLOY AN ADULT WITHOUT LEAVE OR WHO IS SUBJECT TO CONDITIONS AS TO EMPLOYMENT WILL BE LIABLE TO A CIVIL PENALTY UNDER SECTION 15 OF THE IMMIGRATION, ASYLUM AND NATIONALITY ACT 2006 AND PURSUANT TO SECTION 21 OF THE SAME ACT, WILL BE COMMITTING AN OFFENCE WHERE THEY DO SO IN THE KNOWLEDGE, OR WITH REASONABLE CAUSE TO BELIEVE, THAT THE EMPLOYEE IS DISQUALIFIED

OFFICE USE ONLY

Applicant reference number

Fee paid

Payment provider reference

ELMS Payment Reference

Payment status

Payment authorisation code

Payment authorisation date

Date and time submitted

Approval deadline

Error message

Is Digitally signed

☐

1 2 3 4 5 6 7 8 9 10 11 12 13 14 15 16 17 18 19 20 21 Next >

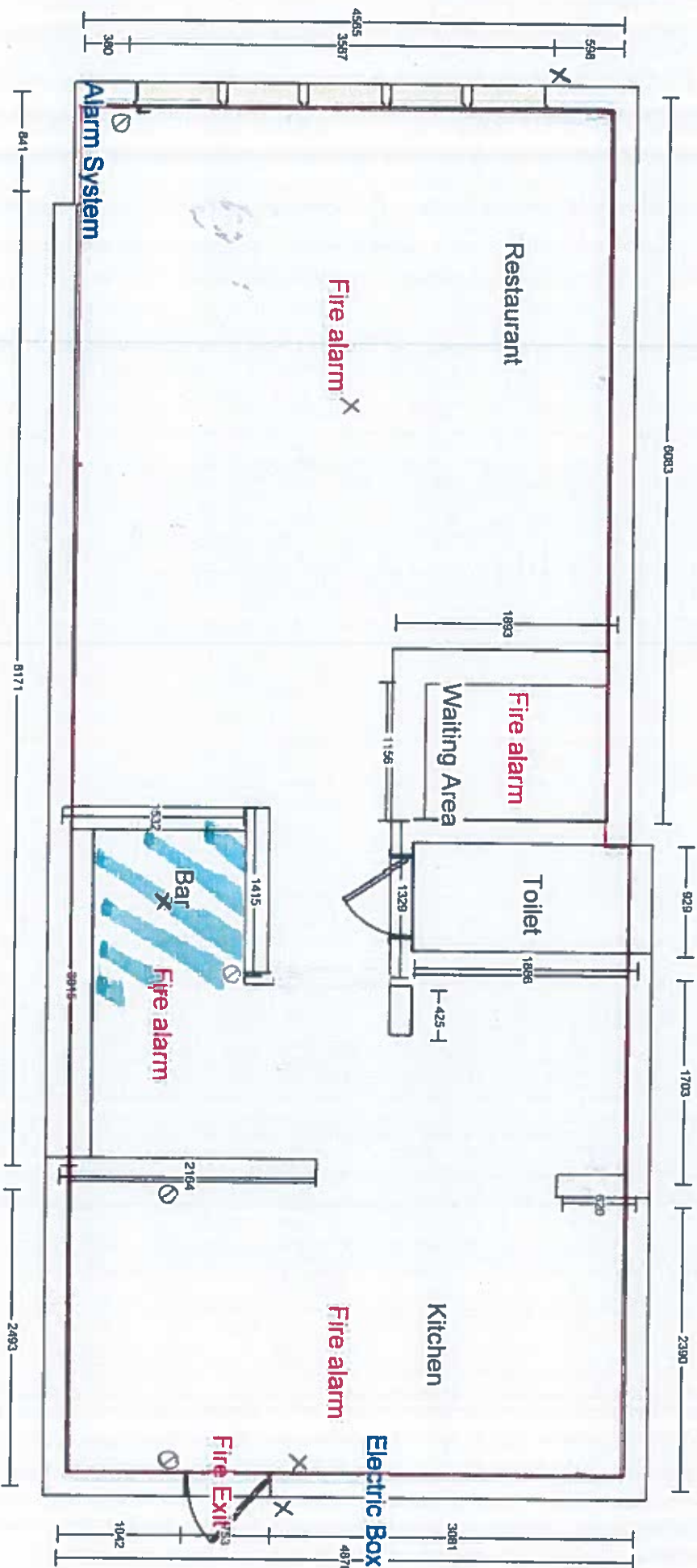

- KEY**
- X - CCTV
 - ⊗ - FIRE EXTINGUISHER
 - - - - - UNCHANGABLE AREA
 - BIFOLD DOORS / MAIN ENTRANCE
 - /// - ALCOHOL STORAGE

HOWDENS		Please consult the quotation for a list of items to be supplied. The drawing is a computer representation of layout and dimension, details should be checked by the installer/builder. Please also ensure a Gas Safe registered engineer is engaged with regards to any gas appliances. Check with your installer/builder for more information.	
Cad Plan No. 20092281451	Customer: STEPHEN ANDREW EDWARD HOUSE		
Designed By: Adam Hewitt-Makri	Phone:		
Designed On: 24/6/20	Range Designed: Alameda Antique White		

Announcements - Public Notices

Notice of Application for a New Premium Licence under the Licensing Act 2003

Notice is given that on the Friday 10th October 2020 that Carl Cookson (Applicant) of The Coach House 1 Premier Road HESGATE WA2 7JE has applied to the Licensing officer of Epping Forest District Council for a Premium Licence in respect of Cafe Carroussel, 262 High Road LUGBURYTON ES10 1TB. The proposed licence is for Sale of Alcohol by Retail (on & off sales); Sunday to Thursday 11.00 - 23.00; Friday & Saturday 11.00 - 00.00; Late Night Refreshments; Sunday to Thursday 11.00 - 23.00; Friday & Saturday 23.00 - 00.00; Late & Refreshment; Music; Friday & Saturday 23.00 - 00.00. The register of licensed premises is maintained at the Licensing Office of Epping Forest District Council, Oak Chase High Street, Gypsy Corner, CM20 4EZ. Applications for premium licences may be inspected at the office during office hours. Anyone wishing to oppose the application must give written notice to the Licensing Officer within 28 days of the notice. It is an offence knowingly or recklessly to make a false statement in connection with an application which could lead to a fine on summary conviction (maximum £5000). Applicant's Agent: Knight Training (UK) Ltd. 0208 888 1788 info@knighttraining.co.uk knighttraining

Working together to help businesses grow

819k+
pages viewed
every month.*

*Source: Omniture Q3 2018

THE ONE-STOP SHOP
FOR YOUR LEAFLETS

- ✓ PLANNING
- ✓ DESIGN
- ✓ PRINT
- ✓ DELIVERY
- ✓ RESEARCH



-ZOOMIN-
LEAFLET SOLUTIONS

CALL 0845 1999 830 OR VISIT
ZOOMINLEAFLETS.CO.UK

EPPING FOREST
Guardian

To discuss your requirements:

020 8884 7420

saleseast@localiq.co.uk

eppingforestguardian.co.uk

guardian-series.co.uk

LOCALiQ localiq.co.uk

**Notice of Application for a New Premises Licence
under the Licensing Act 2003**

Notice is given this day Friday 9th October 2020 that Café Caribbean (Loughton) Ltd of The Coach House, 1 Howard Road, REIGATE, RH2 7JE has applied to the Licensing office of Epping Forest District Council for a Premises Licence in respect of Café Caribbean, 262 High Road, LOUGHTON, IG10 1RB

The proposed licence is for
Sale of Alcohol by Retail (on & off sales): Sunday to
Thursday 11.00 – 23.00, Friday & Saturday 11.00 – 00.00
Late Night Refreshment: Sunday to Thursday 11.00 –
23.30, Friday & Saturday 23.00 – 00.30
Live & Recorded Music: Friday & Saturday 23.00 – 00.00

The register of licensed premises is maintained at the
Licensing Office of Epping Forest District Council, Civic
Offices, High Street, Epping, Essex, CM16 4BZ.
Applications for premises licences may be inspected at
this office during office hours. Anyone wishing to oppose
this application must give written notice to the Licensing
Office within 28 days of this notice.

It is an offence knowingly or recklessly to make a
false statement in connection with an application
which could lead to a fine on summary conviction
(maximum £5000)

Applicant's Agent: Knight Training (UK) Ltd
0330 999 3199 info@knighttraining.co.uk
knighttraining

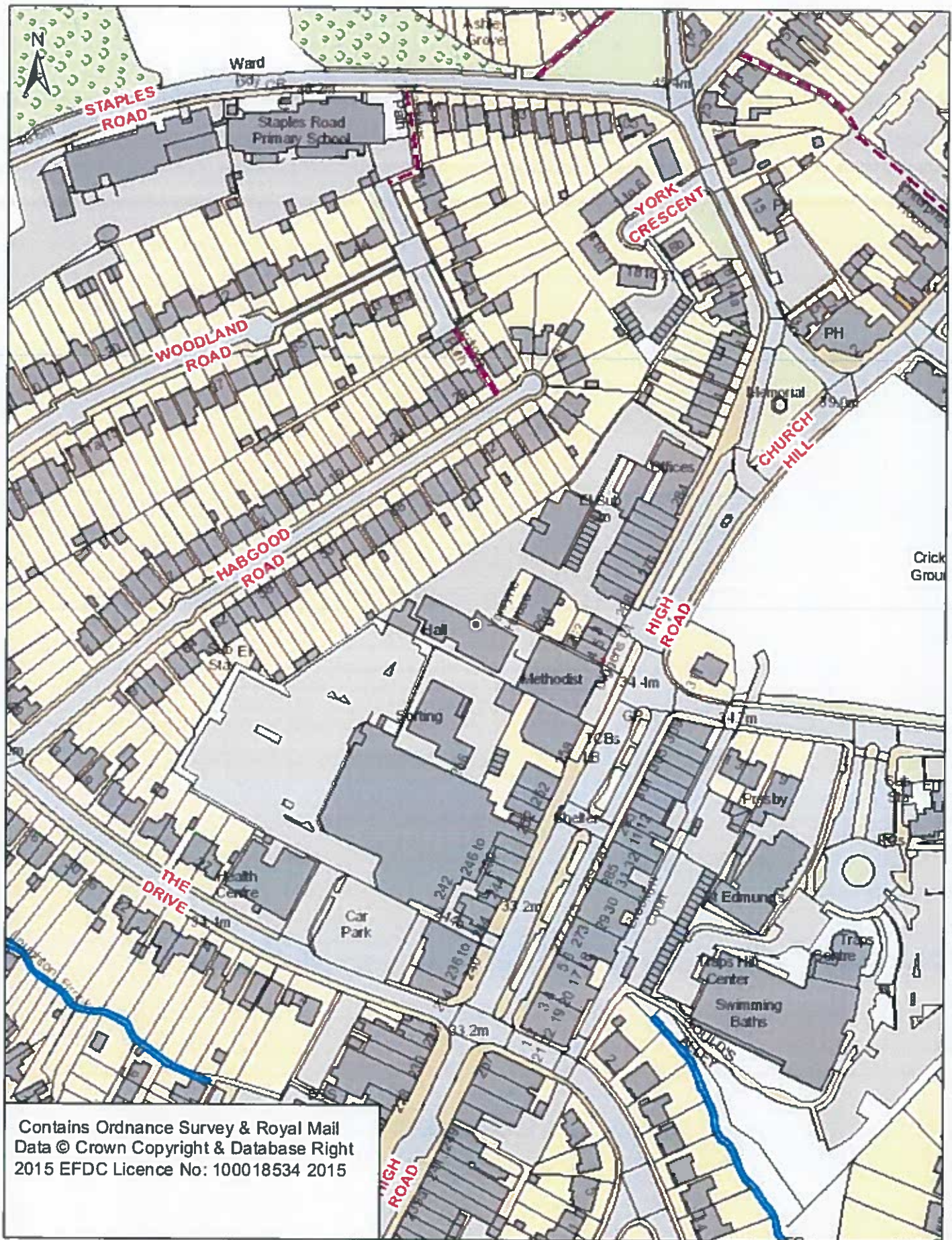

Handan Ibrahim

From: Denise Bastick
Sent: 21 October 2020 10:38
To: Handan Ibrahim
Subject: FW: New Premises Licence Application - Cafe Caribbean, 262 High Road, Loughton, IG10 1RB

From: Cllr.J Jennings <cllr.jjennings@eppingforestdc.gov.uk>
Sent: 09 October 2020 13:31
To: Denise Bastick [REDACTED]

Subject: Re: New Premises Licence Application - Cafe Caribbean, 262 High Road, Loughton, IG10 1RB

Dear Denise

I have a very strong objection to this application on the grounds of noise and disturbance to residential dwellings. This premises is directly below and behind flats and houses and is in a more residential part of the High Road. The opening hours refreshment licence and particularly the music, live and piped until half past midnight and on Friday and Saturday and to half past eleven on Sunday evening are quite unacceptable and will be detrimental to the mental health and well being of the residents.

Regards
Judy Jennings
Councillor St Mary's Ward

Get [Outlook for iOS](#)

From: Denise Bastick <dbastick@eppingforestdc.gov.uk>
Sent: Friday, October 9, 2020 11:02:13 AM
To: [REDACTED]

Subject: New Premises Licence Application - Cafe Caribbean, 262 High Road, Loughton, IG10 1RB

Good morning,

We have received an application for a new premises licence for the above address for a café/restaurant serving Caribbean Food.

The applicant is asking for the following licensable activities:

Supply of Alcohol (both on & off the premises)

Monday to Thursday 11:00 to 23:00

Friday and Saturday 11:00 to 00:00

Sunday 11:00 to 23:00

Provision of Live Music

Friday and Saturday 23:00 to 00:00

Provision of Recorded Music

Friday and Saturday 23:00 to 00:00

Provision of Late Night Refreshment

Monday to Thursday 23:00 to 23:30

Friday and Saturday 23:00 to 00:30

Sunday 23:00 to 23:30

Hours Premises will be open to the public

Monday to Thursday 11:00 to 23:30

Friday and Saturday 11:00 to 00:30

Sunday 11:00 to 23:30

Please note that I have attached an un-redacted copy of the application, DPS consent and premises plan. The application contains personal and sensitive information and therefore is not for public viewing.

Councillor Judy Jennings, Councillor Howard Kauffman and County Councillor Chris Pond have also been included as interested parties.

The consultation will commence on 9th October 2020 and end on 5th November 2020. Please let me have any comments or objections by that date.

Kind Regards

Denise Bastick

Licensing Compliance Officer

Commercial and Regulatory Service Directorate

dbastick@eppingforestdc.gov.uk

Tel: 01992 564334

Working hours Wednesday – Friday

Please contact Mrs Handan Ibrahim, Licensing Compliance Officer

hibrahim@eppingforestdc.gov.uk Tel: 01992 564153

Monday – Wednesday

Handan Ibrahim

From: Debra Paris <Debra.Paris@loughton-tc.gov.uk>
Sent: 20 October 2020 16:37
To: Handan Ibrahim; Denise Bastick
Subject: Licensing Applications Re: New Breed Bottle Shop, 287 High Road, Loughton, IG10 1AH. & Café Caribbean (Loughton) Ltd., 262 High Road, Loughton, IG10 1RB.

CAUTION: This Message originated outside of Epping Forest District Council. Do not click links or open attachments unless you recognise the sender and know the content is safe.

Dear Handan/Denise

Please find below the comments of the Planning & Licensing Committee following its meeting on 19 October 2020:

4.2 Notice of application for a new premises licence under the Licensing Act 2003 in respect of Café Caribbean (Loughton) Ltd., 262 High Road, Loughton, IG10 1RB.

The Committee OBJECTED to this application on the following grounds:

- i) The prevention of crime and disorder
- ii) The prevention of public nuisance.

The position of the premises below and in front of residential properties has the potential to disturb the living conditions of these properties.

Members suggested that hours for all activities are only in line with the rest of licensed premises in the High Road and that music is only played after 9pm inside with the folding doors closed so as not to cause a public nuisance. For the same reasons there should be no provision of late-night refreshment.

I would be most grateful if you could acknowledge receipt of this email.

Kind regards
Debra

Debra Paris
Planning and Licensing Committee Clerk Loughton Town Council
Loughton Library & Town Hall, Traps Hill, Loughton, IG10 1HD
Tel: 020 8508 4200
Fax: 020 8508 4400
E-mail contact@loughton-tc.gov.uk
Web: www.loughton-tc.gov.uk

We are currently operating a skeleton staff in the office, with some staff working remotely, therefore response times may be longer than usual. We appreciate your patience and understanding,

Knitted Poppy Appeal

Please contact us if you would like a poppy pattern for our Remembrance display



Handan Ibrahim

From: Christopher Smith
Sent: 21 October 2020 14:27
To: 'chris@knighttraining.co.uk'
Cc: Denise Bastick; Handan Ibrahim
Subject: WK/202037562 - New Premises Licence Application - Cafe Caribbean, 262 High Road, Loughton

M3PPRef: WK/202037562
M3PPUnique: 000000001BFD40F92E29DB429B3E567BBAEB3F1F07007CAADED4771C84498FBB707361F2622000000943A8300004896016DD8768240A651A88171196D3A000004BD77210000

Dear Chris,

I have been looking over the new premises application for the Café Caribbean, 262 High Road, Loughton.

The application has given me concerns in relation to the noise from both live music and recorded music until the hours you have requested and it causing annoyance/nuisance to nearby noise sensitive properties so I feel that I will need to make a representation.

I can not agree to the application without adding some conditions that would ensure these noise sensitive properties are protected from noise that the premise may make, I hope that we can agree on the conditions.

I would like to propose the following conditions to the premises licence:

1. Doors and windows are to be closed from 21.00hours and whilst live music is being played. This is to control the escape of both people noise and live music.

Reason: To ensure that any music from the licensed premises does not cause a public nuisance.

2. The premises shall be adequately insulated or the sound level adjusted, to ensure that noise from music (live or recorded) or amplified is inaudible inside any adjoining premises. This is to control the escape of music to adjoining properties.

Reason: To ensure that any music and amplified sound from the licensed premises does not cause a public nuisance.

3. An appropriate automatic noise control device must be used for any amplified sound. The device should be set so that the volume of any amplified sound emanating from the premises does not cause a public nuisance. The Premises Supervisor can ensure that any amplified music from the premises does not cause a public nuisance by ensuring that amplified sound is inaudible at the boundary of any properties where the occupiers are likely to be sensitive to noise.

Reason: To ensure that any amplified sound from the licensed premises does not cause a public nuisance and the applicant has an effective method to adequately control the level of amplified sound and music in order to prevent public nuisance.

4. The Premises Supervisor (or representative) shall monitor the volume of music emanating from the premises and adjust the volume to ensure that any amplified sound or other music from the licensed premises does not cause a public nuisance. The Premises Supervisor (or representative) can ensure

that music from the premises does not cause a public nuisance by ensuring that the music is inaudible at the boundary of any properties where the occupiers are likely to be sensitive to noise.

Reason: To ensure that any music and amplified sound from the licensed premises does not cause a public nuisance.

Please come back to me with your thoughts and if you agree to the conditions then I will inform our licensing team so they can be added to the Premises Licence.

Regards

Chris Smith
Environmental Enforcement Officer
Community and Partnerships Directorate
Epping Forest District Council
High Street
Epping
CM16 4BZ

01992 564160
csmith@eppingforestdc.gov.uk



Loughton Residents Association Plans Group



[REDACTED]
Loughton
Essex [REDACTED]
5 November

[REDACTED]
2020
Epping Forest District Council
Licensing Unit Civic Offices
High Street
Epping
Essex
CM16 4BZ

Dear Sir

LICENSING APPLICATION, Café Caribbean 262 High Road Loughton IG10 1RB

We object to this application on the basis of the prevention of public nuisance.

Under the provisions relating to the prevention of public nuisance, we object to the supply of alcohol, both on and off the premises up to 00.00am on Friday and Saturday evenings because of the disturbance this would inevitably cause to residents nearby.

We think that 23.00 is the latest the Café Caribbean should be providing alcohol every evening. Even if the premises are well-sound-proofed, the noise of such customers (and their vehicles) leaving late at night, at a time when other daytime noises are much reduced, would obviously disturb residents.

Also on the grounds of the prevention of public nuisance we also object to the playing of live and recorded music to midnight on Friday and Saturday and to the provision of late night refreshment to 23.30 on Monday to Thursday and Sundays, and until 00.30 on Fridays and Saturday. We think that 23.00 is the latest that the Cafe Caribbean should be playing music and providing refreshment.

Yours faithfully

[REDACTED]
Judith Walker
for Loughton Residents Association Plans Group

Handan Ibrahim

From: Sarah Rosenbloom [REDACTED]
Sent: 15 October 2020 09:04
To: Licensing
Subject: Cafe Caribbean

CAUTION: This Message originated outside of Epping Forest District Council. Do not click links or open attachments unless you recognise the sender and know the content is safe.

Hi there

We are emailing regarding a letter we received in the post re cafe Caribbean in Loughton. Ref WK/202037100

The representation we are concerned about a number of issues relating to the following Prevention of public nuisance. If this premises can remain open till midnight around a very residential area where we live on Habgood Road the noise pollution of being coming and going with the service of alcohol I find extremely concerning.

Kind regards
Sarah Trenam
[REDACTED] habgood road
Loughton

Handan Ibrahim

From: Tim Williams [REDACTED]
Sent: 18 October 2020 20:57
To: Licensing
Subject: Representation AGAINST the licensing application for Cafe Caribbean (Loughton) Ltd

CAUTION: This Message originated outside of Epping Forest District Council. Do not click links or open attachments unless you recognise the sender and know the content is safe.

To The Licensing Team, Epping Forest District Council,

I would like to make a representation AGAINST the licensing application for the supply of alcohol (until 2300 Sunday-Thursday and until 0000 Friday and Saturday), provision of live and recorded music (on Friday and Saturday nights until 0000) and the provision of late night refreshment (until 2330 Sunday-Thursday and until 0030 on Fridays and Saturdays) at Cafe Caribbean, 262 High Road, Loughton, IG10 1RB.

I am the occupant of [REDACTED] Brooklyn Court, High Road, [REDACTED] which is less than 100 metres from the venue in question, and I am deeply concerned that if this licence is granted, a public nuisance will occur as people leaving the venue late at night will create a lot of noise that will affect my ability to sleep and interfere with my rights to quiet enjoyment of my property. This additional noise will augment the existing noise that I am exposed to from passing traffic and people walking along the High Road. I am also concerned that the supply of alcohol at this venue could lead to an increase in anti-social behaviour and other crime in the nearby area.

If any further detail is required then I am happy to be contacted by email [REDACTED] or by phone [REDACTED].

Best wishes,
Tim Williams

Tim Williams MA VetMB PhD AFHEA FRCPath DipECVCP MRCVS
EBVS European Veterinary Specialist in Clinical Pathology
RCVS Recognised Specialist in Veterinary Pathology (Clinical)

Senior Lecturer in Clinical Pathology
University of Cambridge
Department of Veterinary Medicine
Maddingley Road
Cambridge
CB3 0ES
United Kingdom

Director of Studies in Veterinary Medicine
Fitzwilliam College, Cambridge

[REDACTED]

<https://www.hospital.vet.cam.ac.uk/diagnostic-laboratories/clinical-pathology>

Handan Ibrahim

From: Simon Kestenbaum [REDACTED]
Sent: 17 October 2020 15:49
To: Licensing
Subject: Cafe Caribbean Loughton limited

CAUTION: This Message originated outside of Epping Forest District Council. Do not click links or open attachments unless you recognise the sender and know the content is safe.

Dear Sir/Madam,

I am writing to notify you of my objection for extending the licensing hours at Cafe Caribbean.

Loughton High Street has a problem with late night nuisance from revellers and people who have drunk too much at bars and pubs.

if more venues are to offer late night drinking and entertainment this would exacerbate the problem further.

I'm concerned about increased crime, noise and nuisance.

Kind regards,

Simon Kestenbaum

[REDACTED] Habgood Rd, Loughton [REDACTED]

Denise Bastick

From: Contact Us
Sent: 29 October 2020 10:44
To: Licensing
Subject: FW: Cafe Caribbean License Application
Attachments: Cafe Caribbean let 29.10.20.docx

From: Chris Beament [REDACTED]
Sent: 29 October 2020 09:59
To: Contact Us <ContactUs@eppingforestdc.gov.uk>; contact@loughton-tc.gov.uk
Cc: Church Office <administrator@loughtonmethodist.org.uk>
Subject: Cafe Caribbean License Application

CAUTION: This Message originated outside of Epping Forest District Council. Do not click links or open attachments unless you recognise the sender and know the content is safe.

Dear Sir

Please find attached our comments regarding the above license application.

Would you please ensure this communication is passed on to the relevant people involved.

Thanking you in anticipation
Yours sincerely

Chris Beament
on behalf of
Loughton Methodist Church



Epping Forest District Council
Licensing Unit Civic Offices
High Street
Epping
Essex CM16 4BZ

29th October 2020

Dear Sir

Re Café Caribbean License Applications

I am writing to object to the current Café Caribbean (Loughton) Ltd license applications by way of extending their opening hours to the public and providing Late Night Refreshment, Late Night Live and Recorded Music and supply of Alcohol both on and off the premises beyond 22:00.

We are their neighbours at 260 High Road and although since opening they are good neighbours we are concerned about any increased litter on our forecourt if a takeaway service is provided along with any increased noise in the vicinity.

Parking is extremely limited around the High Road. In non-covid times the Church car park is well used by users of our premises, and insufficient to meet our needs at peak times. We are therefore concerned about any non-authorised parking caused by this application particularly if there is any take away activity.

Loughton Methodist Church is community minded and therefore consideration should be given to the whole of the community and not to a part in isolation.

Late night drinkers fuelled with alcohol are not the quietest of people and in recent years premises providing late night alcohol at the other end of the High Road have been the cause of crime and disorder as well as issues around public nuisance and public safety.

The café has a noisy extractor fan and this will be in operation longer and will extend to the emission of food odours. This is unwelcome news to anyone living in the immediate area and in particular the flats above the café.

Minister: Rev Sue Creighton

Church Manager: Cat Davies Tel: 020 85023071 **email:** administrator@loughtonmethodist.org.uk
260 High Road, Loughton IG10 1RB www.loughtonmethodist.org.uk
Charity Commission Reg. No. 1126831



Closing at 22:00 is the neighbourly thing to do. It is a café so other measures worthy of consideration are consumption only on the premises and a delivery service.

In these current Covid times the spirit of the government's message is to curtail and minimise human interaction rather than encourage more of it with longer opening hours.

Thank you for the opportunity to make representations and I hope that you will consider the balanced points made above when considering the Café Caribbean license applications.

With kind regards

Chris Beament
Property Chairman at
Loughton Methodist Church

Denise Bastick

From: John Dessauer [REDACTED]
Sent: 29 October 2020 16:13
To: Licensing
Subject: Register of Licence application received for Café Caribbean (Loughton) Ltd., 262 High Road, Loughton, IG10 1FB
Attachments: Caribbean application.docx

CAUTION: This Message originated outside of Epping Forest District Council. Do not click links or open attachments unless you recognise the sender and know the content is safe.

I attach representation in reference to the above,

John Dessauer
[REDACTED] Hollyoak House
[REDACTED] High Road
Loughton
[REDACTED]

Register of licence applications received**Date application received: 9th October 2020****Applicant Name: Café Caribbean (Loughton) Ltd.****Address of Premises: 262 High Road, Loughton, IG10 1FB**

I write to ask that the licensable activities asked for in the above application be amended. In doing so I accept that the Café Caribbean restaurant is in itself an acceptable establishment. I am however opposing the opening times applied for as I would maintain that the hours applied for would increase late night noise, rowdiness and general anti-social behavior. Men urinating in public nearby have also been noted in recent weeks and an increase in such behavior would be likely. This would no doubt be caused by the number of eating houses in the immediate area and such behavior would be increased by any such increased opening hours and this includes the Café Caribbean.

Below I suggest opening which hours should be imposed in order to prevent noise and nuisance to nearby residences, including recently opened retirement apartments.

Supply of Alcohol (both on & off the premises)

Monday to Thursday	12.00pm to 10.30pm
--------------------	--------------------

Friday & Saturday	12.00pm to 11.30pm
-------------------	--------------------

Sunday	12.00pm to 10.30pm
--------	--------------------

Provision of Live Music

Friday & Saturday	NO
-------------------	----

Provision of Recorded Music	NO
-----------------------------	----

Provision of Late Night Refreshment

Monday to Thursday	NO
--------------------	----

Friday & Saturday	NO
-------------------	----

Sunday	NO
--------	----

Hours Premises will be open to the public

Monday to Thursday	11.00am to 10.30pm
--------------------	--------------------

Friday & Saturday	11.00am to 11.30pm
-------------------	--------------------

Sunday	11.00am to 10.30pm
--------	--------------------

I believe the above opening hours would be acceptable and allow the Café Caribbean and local residents to live in harmony.

PTO

John Dessauer

██████ Hollyoak House, ██████ High Road,
Loughton, ██████

[REDACTED]
[REDACTED] **Pump Hill**
Loughton
Essex [REDACTED]

Tel: [REDACTED]
[REDACTED]
[REDACTED]

25 October 2020

The Licensing Team
Epping Forest District Council
Civic Offices
High Street
Epping
Essex
CM16 4BZ

Dear Sirs

APPLICATION BY CAFE CARIBBEAN (LOUGHTON) LTD

I own Flat No [REDACTED] Diggins Court, 262 High Road, Loughton IG10 1RB and am writing to object to this Licence Application for the following reasons.

1 SUPPLY OF ALCOHOL (BOTH ON AND OFF PREMISES)

The Applicant is applying to supply alcohol on Friday and Saturday up until midnight meaning that people will be able to walk in and buy off sales to drink on the street. The supply of alcohol should not be available after 11pm.

2 PROVISION OF LIVE AND RECORDED MUSIC ON FRIDAY AND SATURDAY BETWEEN 11PM AND MIDNIGHT

This will create a nuisance to the occupants of the flats above the premises and if granted provision should be made for speakers to be free standing not mounted on walls as the boom boom of the bass travels to the properties above as has already been experienced. The premises should be professionally sound proofed and music should stop and 11pm.

3 PROVISION OF LATE NIGHT REFRESHMENT

As the premises is in a residential block the extension to the late night hours should not be granted especially on Fridays and Saturdays to 12.30am as the residents will be trying to sleep. By the time the Cafe has cleared up it will be close to 1am which is totally unacceptable. 11 pm should be the latest.

4 HOURS PREMISES WILL BE OPEN TO THE PUBLIC

As stated in the above comments 11 pm is the latest the Cafe should be open until and the extension after 11 pm should not be granted,

There is no parking available for the premises. The car park at the rear is all allocated to the residents of Diggins Court and Von Ryan House and not available to the public.

Yours faithfully



Peter Spratt

THE LICENSING TEAM
EPPING FOREST DISTRICT COUNCIL
CIVIC OFFICES
HIGH STREET
EPPING
ESSEX
CM16 4BZ

26TH OCTOBER - 2020

DEAR SIRS.
WE LIVE AT NUMBER [REDACTED] DIGGINS COURT IG10 1RB
AND AM WRITING TO OBJECT
TO THIS LICENCE APPLICATION
FOR THE FOLLOWING REASONS
WE BOTH OBJECT THAT 12-00PM, IS TOO LATE
FOR THE MUSIC TO END, AND THE NOISE OF THE PEOPLE COMING
OUT, AND THEY WILL BE STANDING AROUND BEING A NUISANCE
WITH DRINKING AND ALCOHOL.
AND BY THE TIME ALL THE PEOPLE GO HOME, THEN THEY HAVE TO
CLEAR UP IN THE CAFE WHICH WOULD BE GONE 1-00PM.
AND THEN IN THE SUMMER, THEY WILL HAVE THE FRONT DOORS OPEN
AND THEY WILL BE SITTING OUTSIDE, AND THIS IS NOT ACCEPTABLE
WE BOTH HAVE NO PROBLEM
FOR THE CAFE CARIBBEAN (HOUGHTON) LTD
TO SHUT AT 11-00PM SHOULD BE THE LATEST
AS US AND RESIDENTS WILL BE TRYING TO SLEEP.

YOURS FAITHFULLY
D. Richardson
[REDACTED]

Received 30.10.2020

Mob: [REDACTED]

[REDACTED] Diggers Court
262 High Road
Loughton
Essex [REDACTED]

Your Ref: WK/202037100

28 October 2020

Epping Forest District Council
licensing unit civic Offices
High Street
Epping
Essex CM16 4BZ

Dear Sirs,

Re: Licence Application from Café Caribbean (Loughton) Ltd.
Re: The Prevention of public nuisance

My flat is immediately above the cafe so I am concerned about any extended closing hours. Unfortunately the block is not very soundproof and from my past experience any music downstairs tends to get louder as the evening progresses.

Another problem arises when customers leave the premises - they gather outside waiting for taxis etc. and can be extremely noisy! With late closing - especially 00.30 - this could mean it might be 1am before it is quiet again.

Finally I must say that the owners of Café Caribbean are great people and I sincerely hope their restaurant goes from strength to strength.

Yours faithfully

Sheila Brook (MMS)

Denise Bastick

From: jyoti lakhani [REDACTED]
Sent: 25 October 2020 17:27
To: Licensing
Subject: Cafe Caribbean Licensing Permission/ objection
Attachments: Voice 002.m4a; Voice 003.m4a

CAUTION: This Message originated outside of Epping Forest District Council. Do not click links or open attachments unless you recognise the sender and know the content is safe.

Hi I recieved a note saying that cafe Caribbean has requested application for a right to supply alcohol, music, and late night refreshments. Id like to object to all. I live behind the restaurant and its definitely a nuisance, you've given permission to other restaurants i.e turquoise grill and the noise and drunken behaviour from its visitor's is appalling (see attachment).

This is a residential area and should be treated as one, but with noise from the music and its visitor's soo loud it's really problematic. The restaurants always go above the hours they suggest so much so I've called the police on 2 ocassions.

This is really unfair, and this restaurant is soo much smaller which will mean people hanging around outside etc... its just not acceptable. Id urge you to please not grant this permission.

Denise Bastick

From: Denise Bastick
Sent: 05 November 2020 14:13
To: jyoti lakhani
Cc: Handan Ibrahim; Kim Tuckey
Subject: RE: Cafe Caribbean Licensing Permission/ objection

Good afternoon

I have had an opportunity to discuss your representation with my manager, Mrs Kim Tuckey. Initially my manager could not open the audio files. However, after closer inspection, it appears that they relate to noise from another premises. Each application must be treated on its own merit and it is not permissible to use evidence from another premises to make a representation against another application.

My manager has agreed to accept your written representation, but the audio files are not permissible.

Kind regards.

Denise Bastick
Licensing Compliance Officer
Commercial and Regulatory Service Directorate
dbastick@eppingforestdc.gov.uk
Tel: 01992 564334
Working hours Wednesday – Friday

Please contact Mrs Handan Ibrahim, Licensing Compliance Officer
hibrahim@eppingforestdc.gov.uk Tel: 01992 564153
Monday – Wednesday

From: jyoti lakhani <jklakhani@gmail.com>
Sent: 05 November 2020 13:15
To: Denise Bastick <dbastick@eppingforestdc.gov.uk>
Subject: Re: Cafe Caribbean Licensing Permission/ objection

CAUTION: This Message originated outside of Epping Forest District Council. Do not click links or open attachments unless you recognise the sender and know the content is safe.

Please can you confirm whether my objection has been registered.

On Thu, 5 Nov 2020, 13:13 Denise Bastick, <dbastick@eppingforestdc.gov.uk> wrote:

Good afternoon

Unfortunately, as previously stated, we cannot accept the audio files. This is due to technical issues with the Zoom meeting and also, even if this were possible, the audio files would need to be verified by our Environmental Noise Team.